

SPECIFICATIONS

CAPACITY	1500 LBS	MIN HEIGHT	180 MM
MAX HEIGHT	830 MM	AIR PRESSURE	110-120 PSI

FEATURES

1.1. Used for motorcycle lifting.

ASSEMBLY

***The machinery must be installed and commissioned by qualified personnel. All relevant safety regulations must be strictly adhered to! Use the disassemble drawing as your guide to assemble.

Content:

- Main lift
- Clamp
- Ramp
- movable plate
- Pump
- Side plates
- Bolts, Washers, Nuts, Cotter Pins

- 2.1. Take the lift out of the box, make the lift in upright position.
- 2.2. Attach clamp to the front side of the platform
- 2.3. Attach movable plate, ramp to the platform.
- 2.4. Attach pump with hose to the cylinder.
- 2.5. Attach side plates to the platform

BEFORE USE

- 3.1. Purge air away from hydraulic system
- 3.1.1 **Manual operating system:** Let the platform in the lowest position, keep depressing the release foot pedal and quickly pump the lifting foot pedal several times to purge air from the hydraulic system. Release the release foot pedal.
- 3.1.2. **Air operating system:** Pour 2-3 drops of good quality air tool lubricant into the air supply inlet of the lift control valve, connect to air supply and operate for 3 seconds to evenly distribute lubricant.(This step is required if the air pump is not used for a long time)
- Connect the quick coupler-male into the air supply hose quick coupler-female and fully press the release foot pedal, then turn on the air controller letting the pump work for 20 seconds to eliminate any air in the hydraulic system.
- 3.2. Carefully and slowly pinch/turn oil fill plug to release trapped air.
- 3.3. Turn the speed control valve on the oil pump to adjust the lowering speed of the lift **IF NEEDED**.
 - ** Turning it counterclockwise to increase the descending speed.
 - ** Turning it clockwise to reduce the descending speed.
- 3.4. Position the lift in a suitable area, checking that the surface on which the lift will stand is solid and flat.

OPERATION

- 4.1. Ensure that the lift is at the minimum height, the ramp has installed in its place, and turn the support stand down to touch the ground to prevent the lift from moving.
- 4.2. Make sure there is no air in the hydraulic system(Please see **BEFORE USE**), Then move the motorcycle to the centerline of the platform, lock the front wheel with clamp, using tie-down straps (to be ordered separately) to fix the motorcycle to the platform. steadily pump the lifting foot pedal until the platform reaches a required height, or open the air controller to lifting the platform to a required height.
- 4.3. Make sure the safety bar in the low position (Self-Locking position: when the platform raises, the safety bar will automatically lock layer by layer). Then repair the motorcycle.
- 4.4. When work is done, check under the lift to ensure that there are no obstructions and that it is safe to lower the lift. Then use your toes to gently lift up the safety bar extension [21], make the safety bar in the up position.
- 4.5. Depress the release foot pedal, let the lift slowly down to its lowest position.
- 4.6. Open the clamp, untie the straps, remove the motorcycle via the ramp.
- 4.7. Disconnect the air inlet fitting from the air source.

WARNING!!

- 5.1. **DO NOT** exceed rated capacity.
- 5.2. When the platform is at its highest position, Make sure the height limiter is working. **DO NOT** attempt to pump the lift higher as this can damage the mechanism.
- 5.3. Use this lift for lifting purpose only. **DO NOT** use it for any other purpose it is not designed to perform.
- 5.4. Keep children and unauthorized persons away from the work area.
- 5.5. Remove all loose fitting clothing. Remove ties, watches, rings and other loose jewelry, and contain long hair.
- 5.6. Wear ANSI/CE approved safety goggles, glove, shoes, close, helmet when operating the lift.

- 5.7. Only use this lift on a surface that is stable, level, dry and not slippery, and capable of sustaining the load. Keep the surface clean, tidy and free from unrelated materials and ensure that there is adequate lighting.
- 5.8. Always center load on lift platform. When the platform has been raised to the working height, ensure the locking bar is engaged to prevent accidental lowering.
- 5.9. Always keep your hands and feet away from moving parts.
- 5.10. **DO NOT** attempt to transport a load on the lift. The lift must only be used in a static position for lifting and lowering loads. Ensure that the load remains stable at all times.
- 5.11. **DO NOT** operate the lift when you are tired or under the influence of alcohol, drugs or any intoxicating medication.
- 5.12. **DO NOT** allow untrained persons to operate the lift.
- 5.13. **DO NOT** make any modifications to the lift.
- 5.14. **DO NOT** expose the lift to rain or any other kind of bad weather.

WARNING: The warnings, cautions and instructions discussed in this instruction manual cannot cover all possible conditions and situations that may occur. It must be understood by the operator that common sense and caution are factors which cannot be built into this product, but must be supplied by the operator.

MAINTENANCE

- 6.1. Keep the lift clean and wipe off any oil or grease. Lubricate all moving parts.
- 6.2. When not in use, the lift must be stored in the lowest position in a dry location to minimize ram and piston corrosion.
- 6.3. Before each use check all parts, ensure that all applicable bolts and nuts are firmly tightened. If any part of the lift is damaged or suspect, remove the lift from service and take necessary action to repair
- 6.4. Periodically check the ram and piston for signs of corrosion. Clean exposed areas with a clean oiled cloth
- 6.5. Check the hydraulic oil level. If not adequate, add hydraulic oil as necessary. **DO NOT** use brake fluid or any other improper fluid.
- 6.6. If the lift need repairing and/or there are any parts that need to be replaced, have it repaired by authorized and trained technicians and only use the replacement parts supplied by the manufacturer.

TROUBLE SHOOTING

No.	Fault	Cause	Remedy
1	Can't lift up the platform	1. The pump is leaking 2. Release valve not complete closed 3. Air in hydraulic system	1. Replace the oil seals 2. Check the release valve 3. Purge air away, see BEFORE USE , 3.1
2	Can't lower down the platform	1. Speed control valve has been closed 2. Lack of lubrication at the connection 3. Connector has not been tightened.	1. Adjust the speed control valve, see 3.3 2. Apply lubricating oil 3. Check if the connector between the hose and the pump has been tightened.
3	The platform can't reach its highest position	1. The oil is not enough	1. Add oil
4	Oil leaking	1. Seals broken 2. Screw parts loosed	1. Replace the seal kits 2. Tighten the screw parts
5	Air pump can't work	1. Lack of lubrication	1. See BEFORE USE , 3.1.2

PARTS LIST

No.	Description	Qty	No.	Description	Qty	No.	Description	Qty
1	Pin	4	18	Lock nut M8	2	35	Oil fill plug	1
2	Washer φ16	8	19	Nut M8	2	36	Washer φ10	2
3	Pin	5	20	Roller	2	37	Air controller	1
4	Inner support Arm	1	21	Handle sleeve	2	38	Bolt M6×20	8
5	Bolt M16×75	1	22	Pin	2	39	Nut M16	4
6	Cylinder	1	23	Safety bar	1	40	Nut M16	4
7	Outer support Arm	1	24	Roller seat	2	41	Washer φ16	4
8	Handle wheel	2	25	Safety plate	2	42	Bolt M16×120	4

9	Bracing head	2	26	Wheel	2	43	Supporting screw	4
10	Washer $\phi 6$	14	27	Lock Nut M16	3	44	Side plate	2
11	Lock nut M6	6	28	Bolt M16 \times 90	2	45	Bolt M10 \times 20	2
12	Pin	1	29	Ramp	1	46	Ramp	2
13	Hose	1	30	Movable plate	1	47	Pin	4
14	Pump	1	31	Platform	1	48	Flat pin	4
15	Bottom Frame	1	32	Lifting foot pedal	1	49	Nut M6	8
16	Bolt M8 \times 20	6	33	Release foot pedal	1	50	Fixed plate	4
17	Washer $\phi 8$	6	34	Air pump	1	51	Speed control valve	1
CLAMP:								
A1	Nut M10	4	A7	Locknut M10	1	A13	Moveable L tube	1
A2	Washer $\phi 10$	9	A8	Handle	1	A14	Pin	1
A3	Bolt M10 \times 25	2	A9	Washer $\phi 14$	2	A15	Fixed L tube	1
A4	Adjust part	1	A10	R-pin	1	A16	Bolt M10 \times 80	2
A5	Handle pin	1	A11	Cap	1	A17	Cap	4
A6	Handle sleeve	1	A12	Stop tube	1			

DISASSEMBLE DRAWING

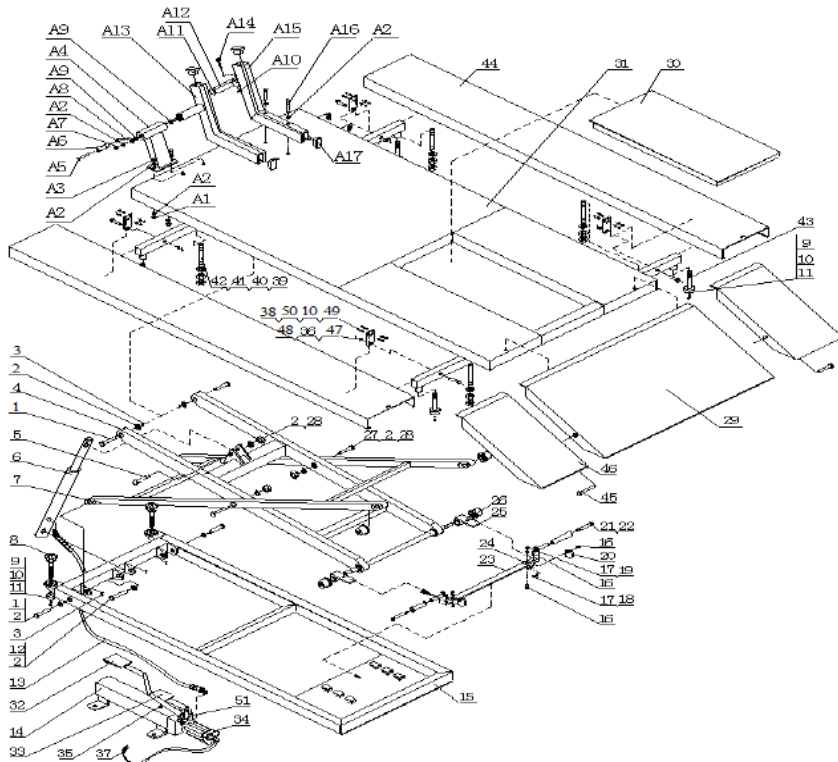

1500LB MOTORCYCLE LIFT

(Air/Hydraulic) INSTRUCTION MANUAL



*****IMPORTANT: PLEASE READ THIS INSTRUCTION MANUAL CAREFULLY BEFORE USE.
NOTE THE SAFETY INSTRUCTIONS & WARNINGS.
USE THE PRODUCT CORRECTLY AND WITH CARE FOR THE PURPOSE
FOR WHICH IT IS INTENDED.
RETAIN THIS MANUAL FOR FUTURE REFERENCE**