

# **Part No. TC2D**

## **Assembly Instruction**

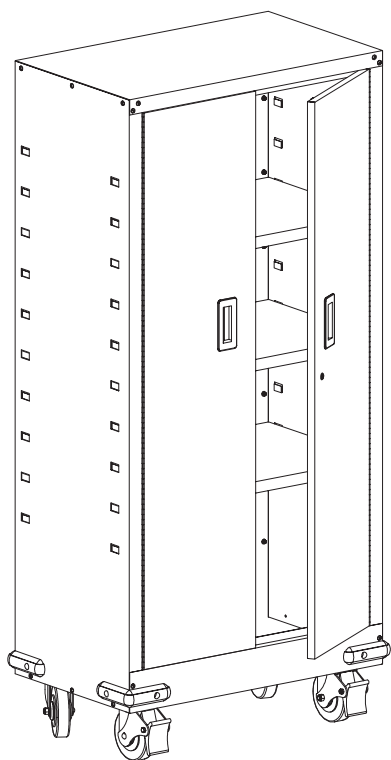

To make assembly easier we recommend having two persons aid one another in assembly.

Item	Description	Qty.	Item	Description	Qty.
1	Right Side Panel	1	11	Swivel Caster	2
2	Left Side Panel	1	12	Caster w/Lock	2
3	Back Panel	1	13	Spacer	16
4	Top Panel	1	14	Hex Bolt	16
5	Right Door w/ Lock	1	15	Small Sheet Metal Screw	8
6	Left Door	1	16	Sheet Metal Screw	24
7	Shelves	3	17	Flanged Lock Nut	50
8	Bottom Panel	1	18	Phillips Head Screw	50
9	Door Handle	2	19	Key	2
10	Corner Bumper	4	20	Washer for Corner Bumper	8

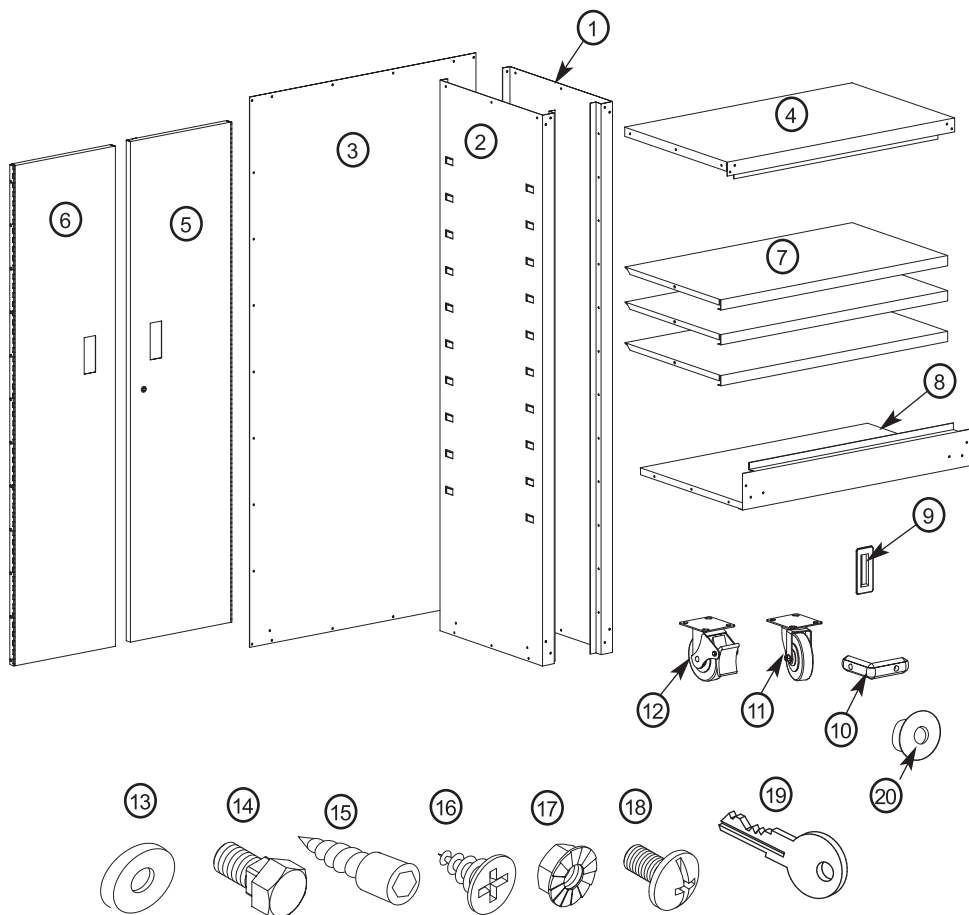

## Tool for assembly

Allen Key



Screwdriver  
(not furnished)



Open Wrench  
(not furnished)

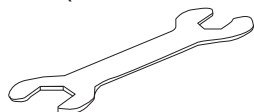

## Step 1:

### SIDE PANELS ASSEMBLY

Attach Side Panels (items 1 & 2) to Bottom Panel (item 8) with Phillips Head Screws (item 18) and secure with the Flanged Lock Nuts (item 17). Align holes on the front and secure with phillips head screws and flanged lock nuts (see illustration below).

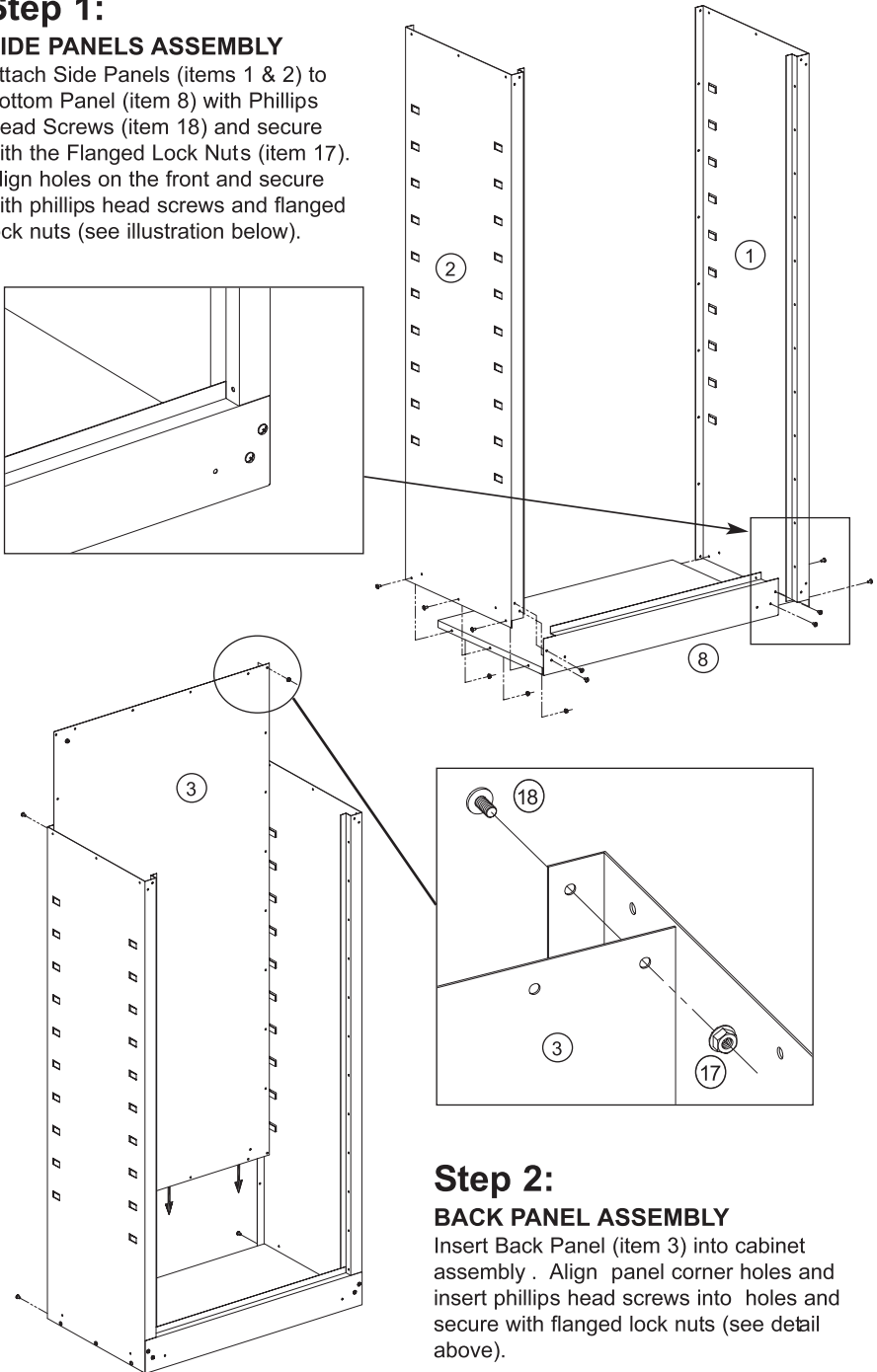

## Step 2:

### BACK PANEL ASSEMBLY

Insert Back Panel (item 3) into cabinet assembly. Align panel corner holes and insert phillips head screws into holes and secure with flanged lock nuts (see detail above).

# Step 3:

## SECURING BACK PANEL

Insert phillips head screws and flanged lock nuts into the side and bottom holes of the back panel as shown.

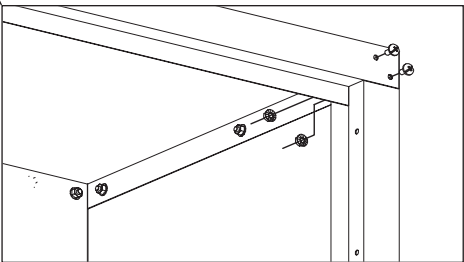
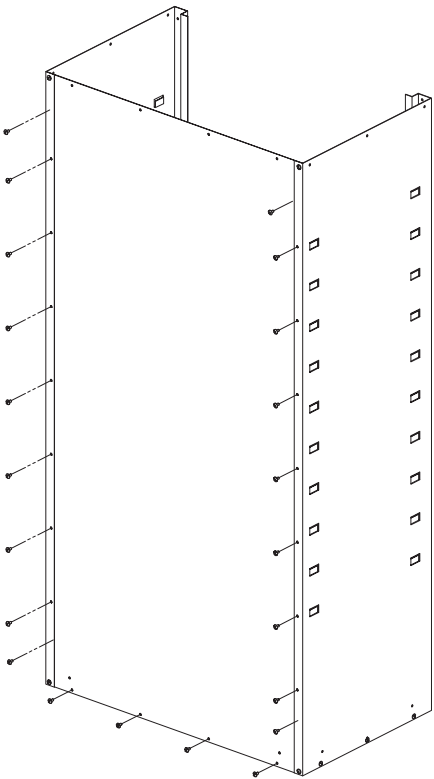
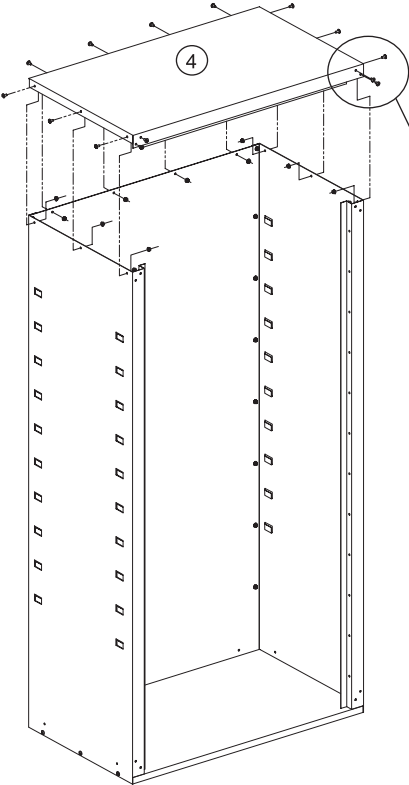

# Step 4:

## TOP PANEL ASSEMBLY

Assemble Top Panel (item 4) to cabinet assembly. Align holes on the sides and back and secure with phillips head screws and flanged lock nuts.

Secure panels in front with phillips head screws and flanged lock nuts (see detail above).

## Step5 :

### CASTER ASSEMBLY

Assemble the swivel casters (item 11) and caster w/Lock (item 12) onto the bottom with the spacers (item 13) and hex bolt (item 14).

Four spacers and hex bolts per caster

Note: Make sure the brake points toward to the front of unit.

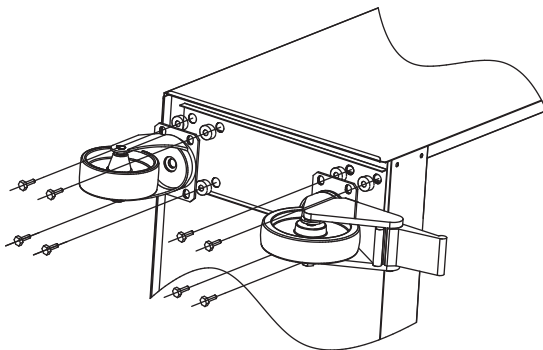

## Step6 :

### ACCESS DOOR ASSEMBLY

Align the holes on the hinges of the left door to the holes on the side panel on the cabinet and secure together with Sheet Metal Screws (item 16 ) (see illustration below).

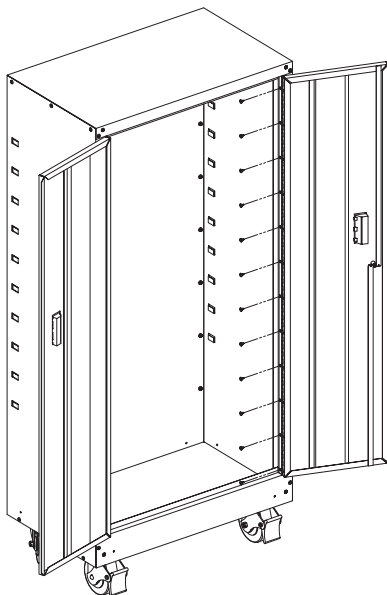
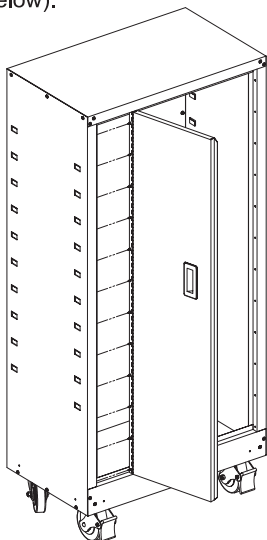

Repeat previous step to attach the right door with lock to the cabinet assembly (see illustration above).

## Step 7:

### INSTALLING SHELVES

With the doors open insert a Shelf (item 7) into cabinet, determine the height of your shelf and secure by inserting its edges of the shelf into the tabs on the right and left (see detail below).

Repeat step or other shelf.

Load capacity for each shelf should not exceed 80 kg/176 lbs.

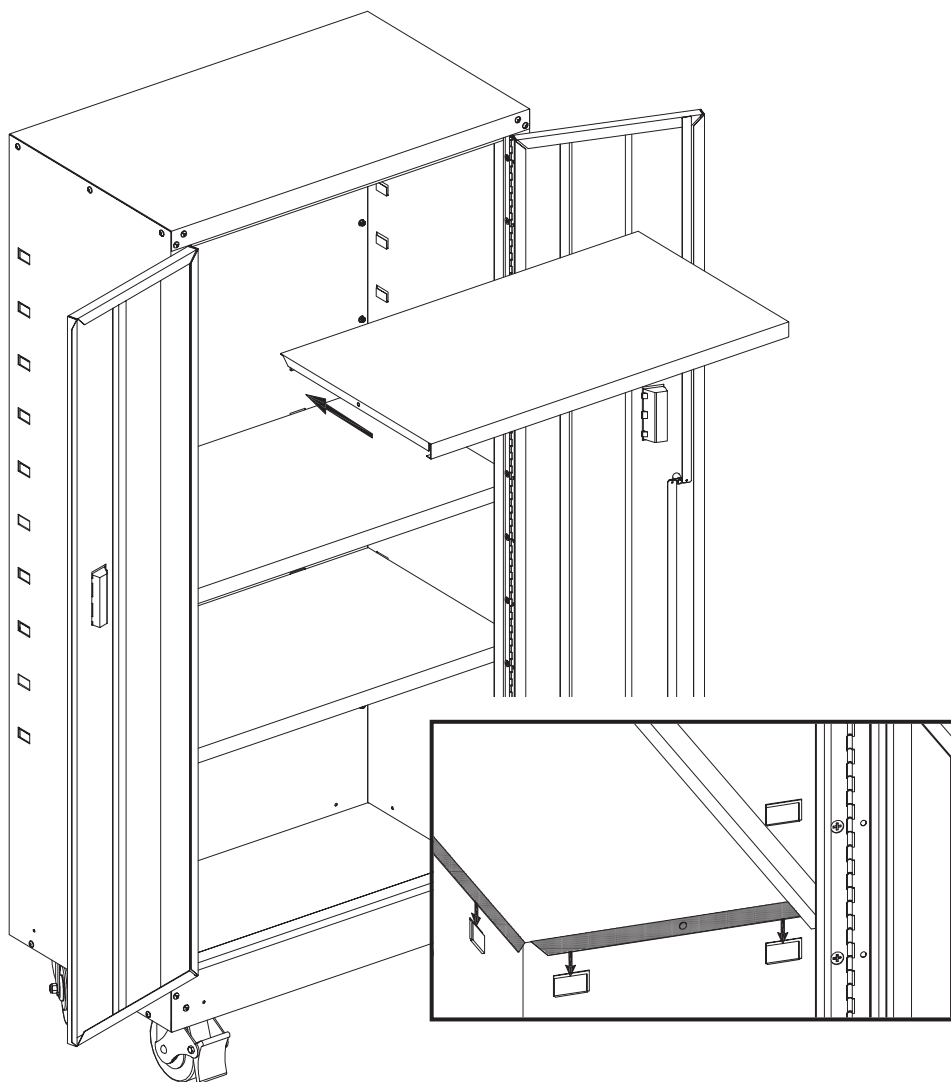

## Step 8 :

### INSTALLING CORNER BUMPERS

Insert a Small Sheet Metal Screw (item 15) and a washer (item 20) into a hole on the Corner Bumper (item 10) and use the tip of the screw to align to the holes on the bottom of the cabinet. Secure the bumper with a second small sheet metal screw. Repeat for all bumpers.

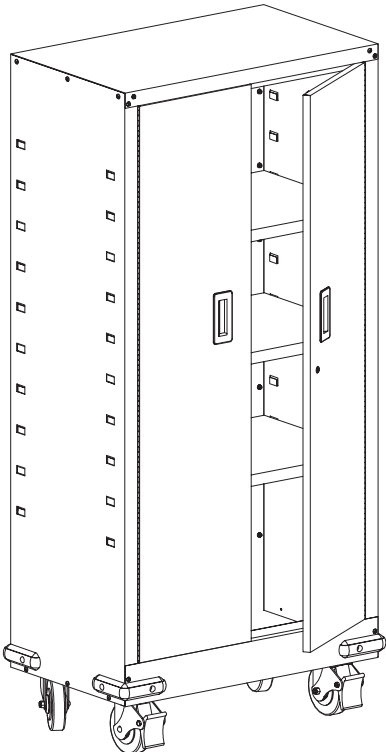
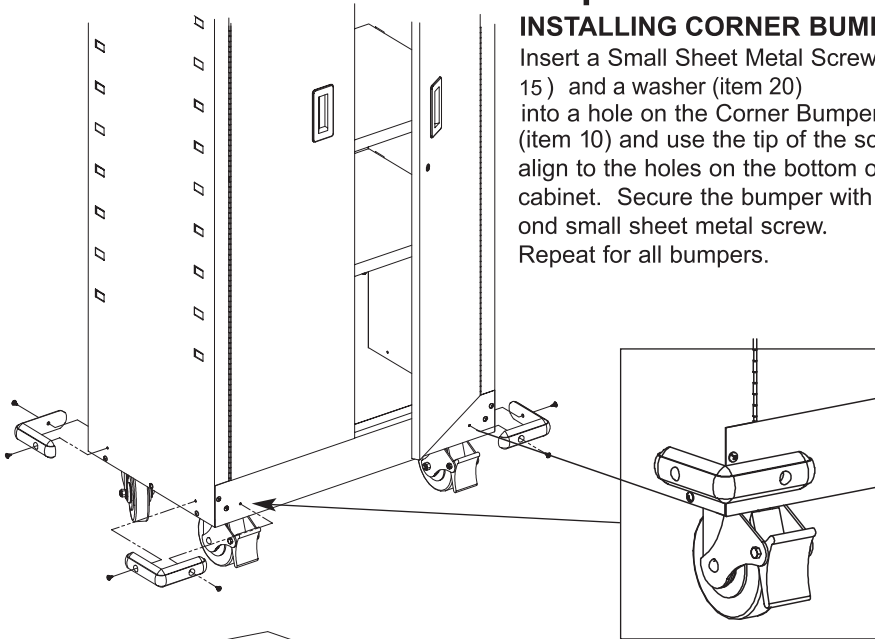

**Congratulations on  
your completion!**